



RETRACTABLE SCREEN FOR WINDOW ASSEMBLY INSTRUCTIONS

SUGGESTED MAXIMUM DIMENSIONS
H = 250 cm W = 160 cm

Cod. IMZ011

JUNE 2003

1 MEASURE WIDTH (W) AND HEIGHT (H) OF THE OPENING

Example:

H = 160 cm
W = 100 cm

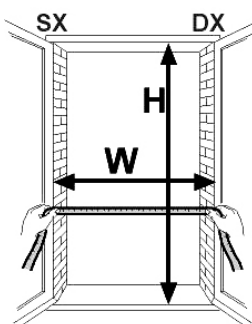

ATTENTION!
SX = LEFT DX = RIGHT

2 CUT THE SCREEN CASSETTE AND THE HANDLE BAR

Cut the screen cassette and the handle bar
(without removing the plastic packaging)
2,5 cm SHORTER than the measured
width.

Example:

W (100) = Cut 97,5 cm

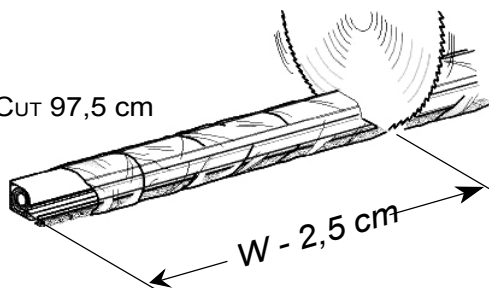

3 CUT THE SIDE CHANNELS

Cut the side channels 8,2 cm SHORTER
than the measured width.

Example:

H (160) = Cut 151,8 cm

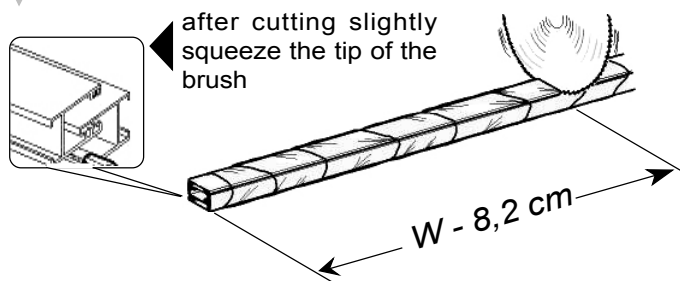

ASSEMBLE THE CAP (DX) TO THE CASSETTE

4

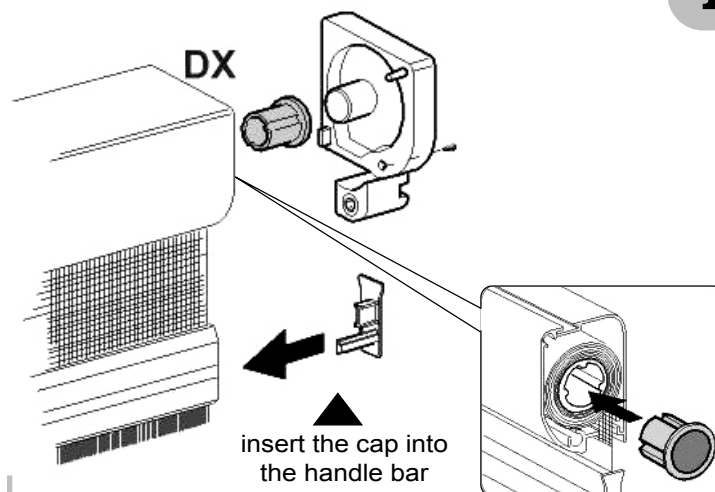

INSERT AND LOAD THE SPRING

5

Push the spring in depth WITHOUT
INSERTING THE CAP and load it with
an Allen key. For the right number of
turns refer to the spring loading table.
After loading, fix the cap and block it
with the screw (V).

ATTENTION: before inserting and
loading the spring, make sure the
screen is perfectly tight-fitting to the
tube (it could get loose while cutting).

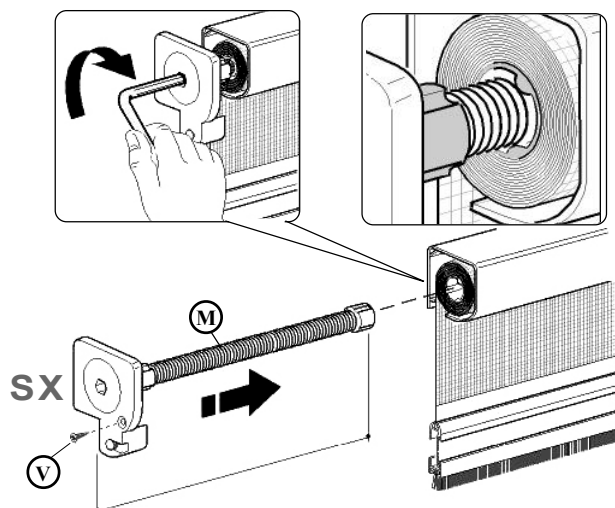

SPRING LOADING TABLE

size (W x H)	spring lenght (M)	loading turns
80 x 160 cm	42 cm	12
100 x 160 cm		14
120 x 160 cm		18
140 x 160 cm		18
160 x 160 cm		18
80 x 250 cm	60 cm	18
100 x 250 cm		18
120 x 250 cm		20
140 x 250 cm		22
160 x 250 cm		24

6

INSERT THE COMPONENTS (A) (B) (C) INTO THE HANDLE BAR

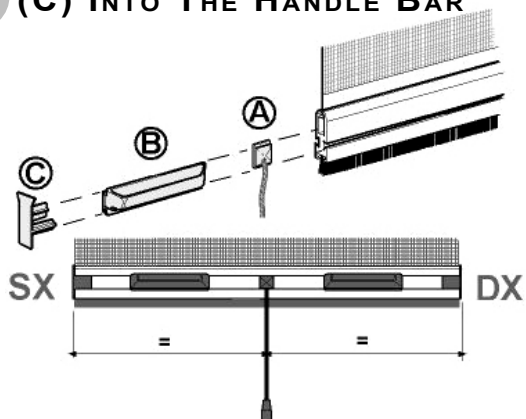

7

ASSEMBLE THE ENDCOVERS TO THE CASSETTE AND INSERT THE CASSETTE INTO THE WINDOW OPENING

Assemble the endcovers (D) with the springs (E) to the cassette.

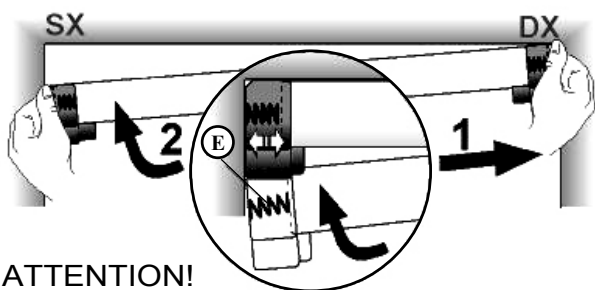
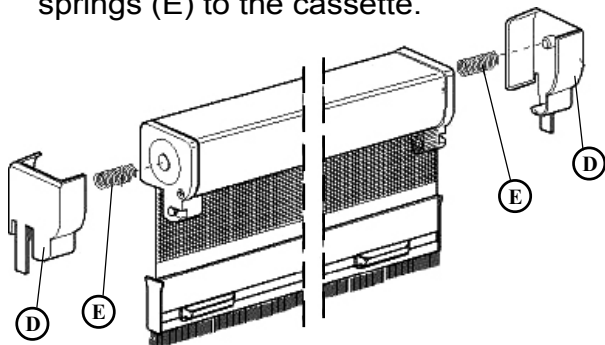

ATTENTION!

If the box has been accidentally cut too short, such error (1 cm maximum) can be made up while carrying out final adjustments.

8

INSERT THE SIDE CHANNELS INTO THE PLUGS

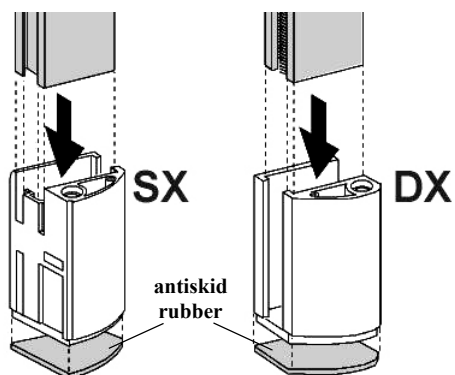

INSERT THE SIDE CHANNELS INTO THE CASSETTE

9

9A - 9B OPTIONAL

If the openings are particularly uneven, it is advisable to secure the side channels (G) with the little plate (P) provided. Make a hole ($\varnothing 10$) and fix the plate with the screw and the dowel (also provided).

9C - Insert the side channels into the screen cassette

9D - Secure the cassette and the side channels by tightening with the Allen key and the mont plastic caps (T)

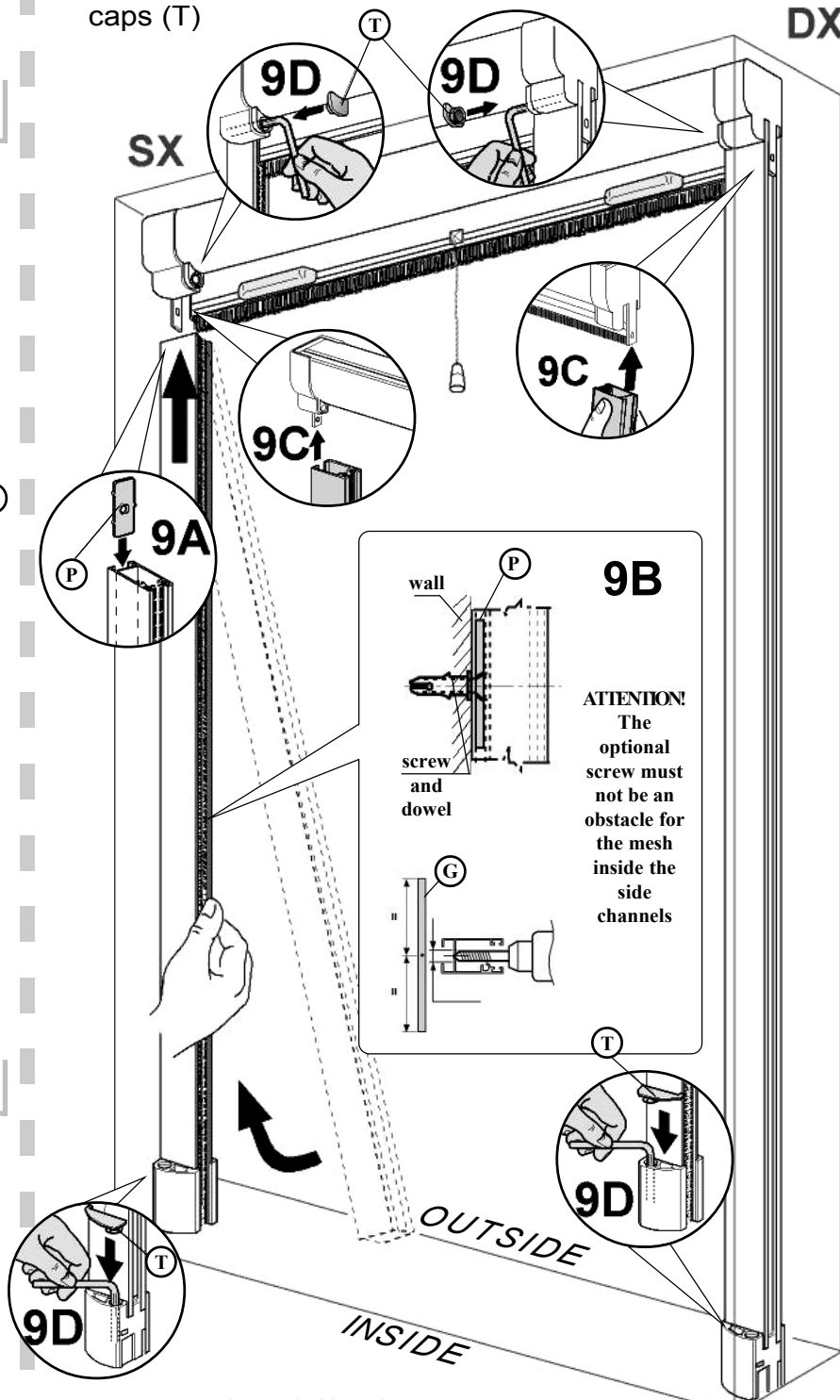

ATTENTION: MEDAL S.r.l. reserves the right to make any changes to its products and to their technical characteristics as it deems fit and opportune. The drawings are given for reference only and may therefore not be a true and faithful representation of the product in all its details. They are simply meant to provide illustration of the mounting procedure.

ATTENTION: all instructions and recommendations are to be closely adhered to. The purchaser of the BAZAR retractable screen holds the manufacturer harmless for any consequences deriving from the use of the retractable screen itself especially if the instructions have not been fully and duly complied with.



MEDAL S.r.l. Via dell'industria, 12 - 40023 Castel Guelfo (Bo) - ITALY
Phone +39.0542.37.01.01 Fax +39.0542.67.01.28 e-mail: info@medal.it